

# User Manual

Cygnus / Siryon

**FORESTAL**



# Introduction

You are about to embark on a journey that combines nature and technology. Thank you for choosing Forestal.

Your new Forestal is the combination of many years of design and development by a team of passionate bicycle lovers, and we're extremely grateful that you have chosen to join us. We hope that you enjoy riding your new Forestal as much as we have producing it for you. Take to the trails, hit the road, and enjoy our unique fusion of nature and technology.

This manual will serve you as a general guide on how to unbox, assemble, use and maintain your bicycle. It will also provide you with general information on liability, safety and keep you aware of potential dangers that may occur when operating your bicycle.

At Forestal we consider sustainability at every step, this is why we have developed our packaging to be reusable. Using high-quality packaging ensures your bike arrives in perfect condition and also enables you to reuse the box for transportation or storage.

This manual contains useful safety information that will help you to understand your bicycle. We strongly recommend that you read it.

Before your first ride, please download Forestal Sync App by scanning the QR CODE below. To activate the warranty and safety features it is mandatory to register your bike via the Forestal Sync App.



Please scan this QR Code to download  
Forestal Sync App for Apple iOS.



Please scan this QR Code to download  
Forestal Sync App for Android.

# Table of Contents

<b>A</b>	Introduction	1	<b>G</b>	Warranty	44
<b>B</b>	Illustration of Symbols	3		Rewind programme	45
<b>C</b>	General Safety	4	<b>H</b>	Disclaimers and Warnings	46
<b>D</b>	Maintenance and Transport	6	<b>I</b>	Declaration of Conformity	47
	Cleaning the bicycle	6			
	Cleaning the drivetrain parts	6			
	Maintenance schedule	7			
<b>E</b>	Unboxing and setting up				
	your bike	8			
	Content of the bicycle box	9			
	Bicycle parts	10			
	Setting up your bicycle	11			
	Brakes instructions	19			
<b>F</b>	Technical Characteristics	20			
	Frame anatomy Cygnus	22			
	Geometry chart Cygnus	23			
	Seatpost insertion Cygnus	24			
	Frame specifications Cygnus	25			
	Suspension curve Cygnus	26			
	Rear spacing Cygnus	26			
	Torque diagram Cygnus	27			
	Exploded view Cygnus	28			
	Frame anatomy Siryon	32			
	Geometry chart Siryon	33			
	Seatpost insertion Siryon	34			
	Frame specifications Siryon	35			
	Suspension curve Siryon	36			
	Rear spacing Siryon	36			
	Torque diagram Siryon	37			
	Exploded view Siryon	38			
	Components torque table	41			
	Internal storage	42			
	Storing the bicycle	43			
	Transportation	43			
	Adjustment of gears and operation	43			



# Illustration of Symbols

Meaning and explanation of symbols:



## **Tip symbol**

Provides the user with additional knowledge on the subject.



## **Note symbol**

Provides important information to avoid potential problems.



## **Information symbol**

Provides additional information that will help users to understand the situation more clearly.



## **Caution symbol**

Warns about a situation that can cause potential material damage if users don't follow the instructions.



## **Warning symbol**

Warns about a situation that can cause serious physical injury, death, and/or heavy material damage if one does not obey the safety instructions.



## **Attention symbol**

Take special care of the object or action.



## **Disclaimer symbol**

Statement of clear liability.

# General Safety

To ensure safety, quality, and reliability, use only original parts or Forestal authorized parts for repair and replacement.



Use your bicycle responsibly within the limits of your capabilities. Mountain biking and road riding is considered as dangerous activity and can result in injury, even at slow speeds. Stunt riding, jumping your bicycle, riding at high speeds, racing, and other types of extreme riding is considered extremely dangerous, and increases your risk of injury and/or death. Even with the most advanced safety gear, you could become seriously injured or killed when stunt riding, jumping, riding at high speeds or competing.

To decrease your risk of injury, know your limits, use your bicycle correctly, and always wear helmet and appropriate safety equipment and before every ride, inspect your bicycle for irregularities or loose parts. If you notice anything strange or suspicious such as deep scratches, squeaks from components/frame, or a sudden drop in performance of electrical components of your bicycle, please contact us or your nearest Forestal representative for further advice.



Improper assembly or adjustment of the bicycle's components can result in serious injury or damage to the bicycle. It is essential that all parts, including the wheels, brakes, handlebars, headset, pedals, and drivetrain, are installed and adjusted according to the manufacturer's specifications. If you are unsure of how to correctly assemble or adjust any component, seek assistance from a qualified technician. Failure to do so may compromise the safety, performance, and durability of your bicycle. Always check that all parts are securely fastened and functioning properly before riding.



Make sure to follow the traffic rules and regulations of the country where you are intending to use your bicycle. You will be able to find out more information from local authorities. If you are riding on the public roads, you are obligated to use all the lighting, signalling and warning devices.



**Increased Braking Distance in Wet Weather.** Wet or slippery conditions can significantly increase the distance required to stop your bicycle safely. Water on the rims, tires, or brake pads reduces braking efficiency, and it may take longer for the brakes to respond. Exercise extra caution when riding in wet weather, allowing more time and distance for braking. Always reduce your speed and avoid sudden or hard braking to maintain control. Regularly inspect and maintain your braking system to ensure optimal performance in all conditions.



Never exceed recommended measurements on tyre width or maximum and minimum insertions of the seat post. Adhere to all torque and sizing specifications for press fits and thread fits. Over-tightening can damage threads or cause parts to fail. Failing to follow these instructions can result in serious injuries or damage to the bicycle.



For composite components, impact damage may not be visible to the user. In the event of an impact or accident, composite components should either be returned to the manufacturer for inspection or destroyed and replaced to ensure safety.



For composite components, be aware that exposure to high temperatures or radiation in a confined environment can cause damage to them.



Tampering typically refers to unauthorised modifications, alterations, or manipulations of the product that may affect its functionality, safety, or compliance with manufacturer standards



Tampering with a bike, such as altering components, bypassing safety features, or using non-compliant parts, can compromise safety, reduce performance, void warranties, and increase the risk of accidents by disrupting critical systems like brakes or steering.



When there is an issue with the handlebar, the rider's response to steering and braking can be adversely affected,

# Maintenance and Transport

Regular maintenance will prolong the life of your bicycle and ensure it is safe to ride.



Make sure to regularly clean your bicycle and check for wear. Replace worn parts as necessary.



For information on after-sales service and the supply of spare parts use only original Forestal spare parts available from our website, contact us at [contact@forestal.com](mailto:contact@forestal.com)



Never use a high-pressure washer near electronic, pivots, or suspension components of the bicycle.



Do not clean components with excessive water. If the internal electrical parts are infected with water, the insulator may corrode which could lead to a power drain or other electrical problems.



Using non-neutral soap solutions may lead to colour change or colour distortion on some plastic parts of the bicycle or carbon frame.



For appropriate spares of your bicycle i.e. tyres, brakes, tubes, etc, please contact your local bicycle shop.



Make sure to equip your bicycle with all the necessary reflective accessories, lights and signalisation devices when used in the public roads.

## Cleaning the bicycle

Never use a high-pressure washer near electronic parts and always use neutral soap for frame and components cleaning. Bear in mind that this is still bicycle with electronic part and need to be treated like any electronic device. Failure to follow these instructions can lead to damage to electronic system.

## Cleaning the drivetrain parts

Chain and drivetrain parts are the most exposed moving parts of the bicycle. By keeping them clean you are preventing premature wear and tear of the chain and drivetrain sprockets. You can clean the chain and drivetrain parts with a dedicated chain degreaser. Make sure that while cleaning, degreaser, oil or grease doesn't come into contact with disc/rotors and brake pads! After cleaning ensure a quality lubricant is used on the drivetrain.

## Maintenance schedule

## Before every ride

Check the frame and fork for signs of stress: scratches, cracks, dents, deformation or discolouration.

Inspect the chain-stay guard and ensure it is correctly and securely attached.

Check that the wheels are in good conditions.

Check the tyre pressure.

Check the brakes, including brake pads and brake lines.

Check that both wheels are secured.

Check that the handlebar and stem are correctly positioned and inspect for signs of stress: scratches, cracks, dents, deformities, and discolouration.

Check that the suspension settings are at your preferences.

Check that the saddle is correctly positioned and tightened.

Check the smooth shifting operation.

Lubricate the chain.

## Weekly

Check that all bolts are tightened to proper torque specifications. Make sure to include pedals and any accessories or luggage carriers.

Check the rims and spokes for damage.

Clean and degrease the bicycle.

Check the tyres for damage and wear.

Clean dust on suspension seals.

## Monthly

Check the shifter and brake cables for wear.

Check that the headset is adjusted correctly.

Check that the chain is not worn.

**Every  
3 months**

Inspect the drivetrain for wear.

Inspect the crank arms and pedals.

Check tyre sealant levels.

Inspect suspension parts for wear.

## Annually

Annual servicing at your dealer: overhaul service and inspection of frame, suspension, and all other components. Repair, service, and/or replace parts as needed.

This list provides some guidelines, but is not to be considered a complete inspection from arising. Following these guidelines will help maintain the performance of your bicycle and prevent more serious problems from arising. It is important to remember that service intervals can vary depending on climate, trail conditions and riding cadence. For service instructions for your specific components, visit the manufacturer's website. If you detect any problems with your bicycle, and you are not able to repair them, take your bike to your authorised dealer for service problems.

# Unboxing and setting up your bicycle

Congratulations, you have successfully reached your bicycle's assembly stage. Please follow the steps carefully in order to safely assemble your bicycle.



Forestal's bicycle box and packaging are fully recyclable and we strive to minimise the use of single-use plastics.



Handle the tools and box with safety in mind. By assuming this task, you are taking full responsibility for your safety.



Necessary tools for assembly:

- Tyre pump
- Suspension pump
- 6mm hex key
- 5mm hex key
- 4mm hex key
- T25 torx key
- Torque tool (supplied)



Put the other part of the box to one side.



Follow the instructions on the box to open it from correct side.



Please scan this QR Code for extended and detailed user manual.



Please scan this QR Code to download Forestal Sync App for Apple iOS.



Please scan this QR Code for external assembly video manual.



Please scan this QR Code to download Forestal Sync App for Android.

## Content of the bicycle box

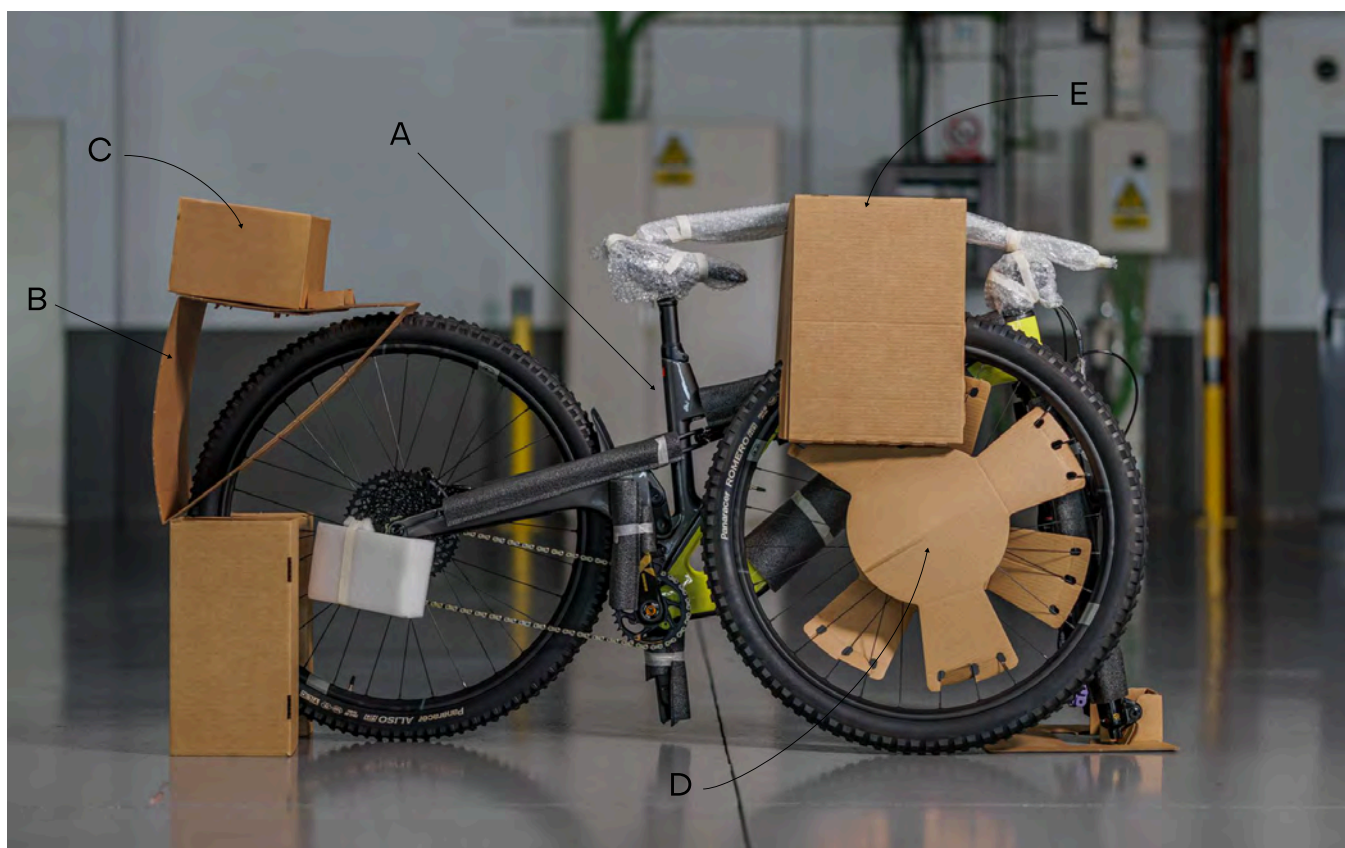

- A** Forestal bicycle
- B** Wheel holder
- C** Accessory Box:
  - Lezyne x Forestal tool\*
  - User Manual
  - Reflectors kit
  - Lights
  - Warranty documentation
- D** Front wheel
- E** Handlebar



If bicycle is bought directly from Forestal's website, you can expect unpacking procedure as shown in the illustrations, together with an additional accessories inside the box.

\*Only included in special edition version

## Bicycle parts

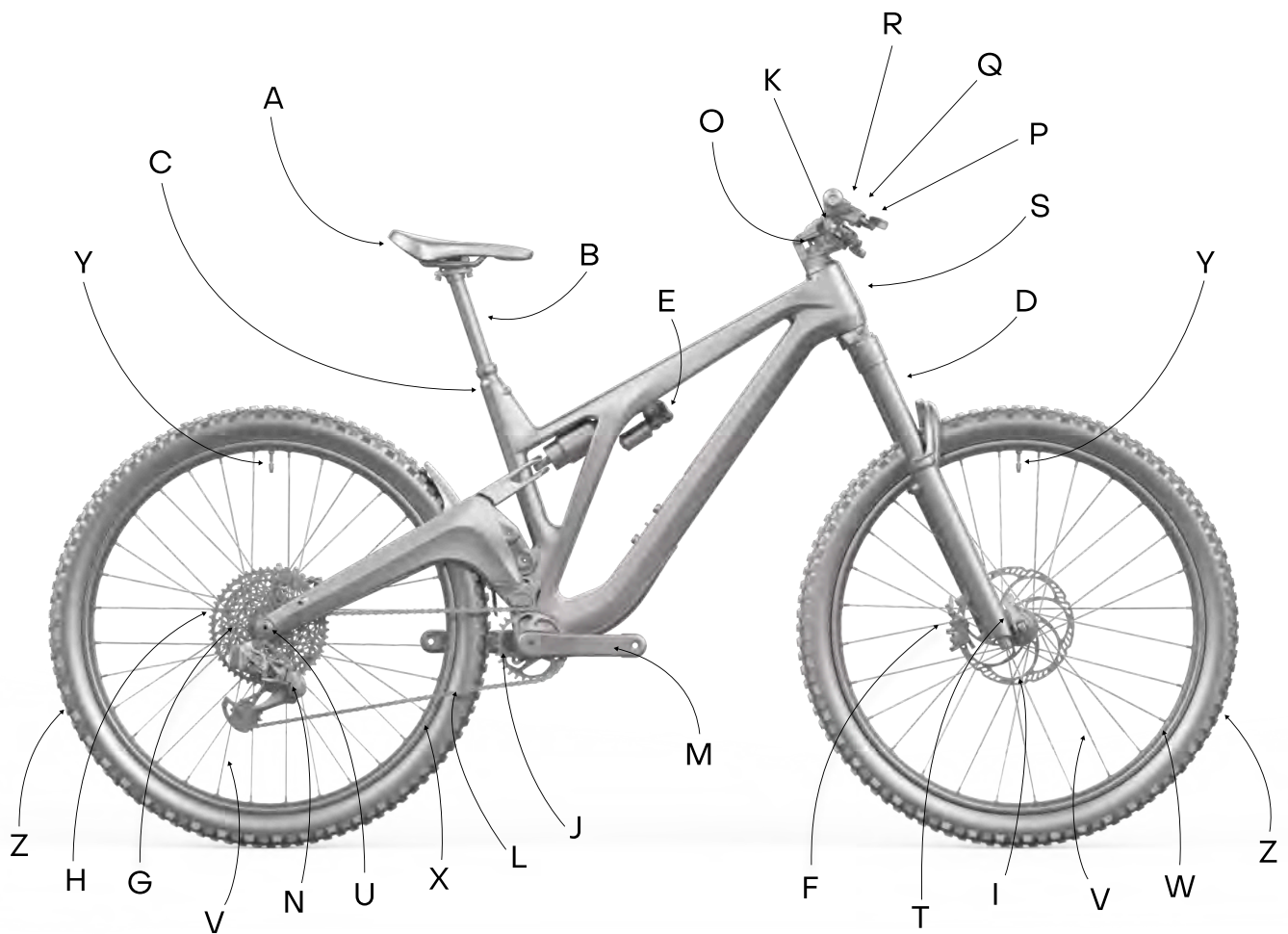

- |  |   |
|--|---|
| <b>A</b> Saddle                            | <b>N</b> Rear derailleur - 12 speed     |
| <b>B</b> Seat-post - $\varnothing$ 31.6    | <b>O</b> Stem - $\varnothing$ 31.8      |
| <b>C</b> Seat-clamp - $\varnothing$ 34.9   | <b>P</b> Brake lever                    |
| <b>D</b> Fork                              | <b>Q</b> Handlebar - $\varnothing$ 31.8 |
| <b>E</b> Shock                             | <b>R</b> Shifter - 12 speed             |
| <b>F</b> Front brake calliper - Post Mount | <b>S</b> Headset - ZS56/ZS56            |
| <b>G</b> Rear brake calliper - Post Mount  | <b>T</b> Front hub - 110 x 15 mm        |
| <b>H</b> Cassette - 12 speed XD body       | <b>U</b> Rear hub - 148 x 12 mm         |
| <b>I</b> Disc - 6 bolt                     | <b>V</b> Spokes                         |
| <b>J</b> Chainring - DM                    | <b>W</b> Front rim - 31.5 inner width   |
| <b>K</b> Dropper-post trigger              | <b>X</b> Rear rim - 29.5 inner width    |
| <b>L</b> Chain - 114 Chain eyes            | <b>Y</b> Valve - Presta                 |
| <b>M</b> Crankset - DUB                    | <b>Z</b> Tyres - 29"                    |



## Setting up your bicycle

In the next few steps, you will learn how to adjust your bicycle to unlock the full potential and fully enjoy your ride.

Necessary tools for assembly:

Tyre pump / Suspension pump / 6mm hex key / 5mm hex key / 4mm hex key / T25 torx key / Torque tool

### Inflate the tyres



Tyre pressure should be between 1.6 bar (23.2psi) and 3.6 bar (52.2psi). Please do not inflate the tyres beyond the maximum pressure as indicated on the tyre. The optimal tyre pressure depends on the rider's weight, the terrain and personal preferences.



Please occasionally check your tyre pressure as low tyre pressure may lead to lack of control and a major risk of damaging your tyres, tubes, rims and a sudden tyre pressure loss. On the other hand, too high tyre pressure may lead to a significant lack of grip, lack of comfort and control, and risk of damaging the tyre.

### Install the pedals



Left and right side pedal threads are different. The left pedal is a non-drive side pedal and it should be threaded counter-clockwise. The right side pedal has a regular thread and it is threading clockwise.



Pedals are included in the box for all electric bicycles.

## Adjust the seat height.



Extend the dropper post by pressing the left lever with the left thumb, then adjust the approximate height of the seat, and tighten the saddle with 4mm hex key. Sit on the seat and assess the height by placing your heel on the pedal and rotating the crank to the lowest position. If the leg is fully extended while your heel is on the pedal and you are sitting comfortably on the seat, this means you have the right seat height. If not, please repeat the process until you reach the correct seat height.



Observe the minimum and maximum insertion on the dropper post and never exceed it. By exceeding it, you are risking frame damage and injuries.

## Adjust suspension pressure



Adjust suspension pressure only with a high-pressure suspension pump. The air chamber for Rock Shox and Fox front suspension is located on top of the left leg while Öhlins uses the right leg for its air chamber assembly. Unscrew the protective cap from the top and attach the suspension pump.



Rear suspension air valve is usually located on the side of the shock.



Air pressure in air forks and shock need to be precisely adjusted to your weight before the first use of the bicycle. You can find detailed instructions on how to set up your suspension air pressure in our Suspension setup guide in: [www.forestal.com/usermanuals](http://www.forestal.com/usermanuals)

## Install the front wheel

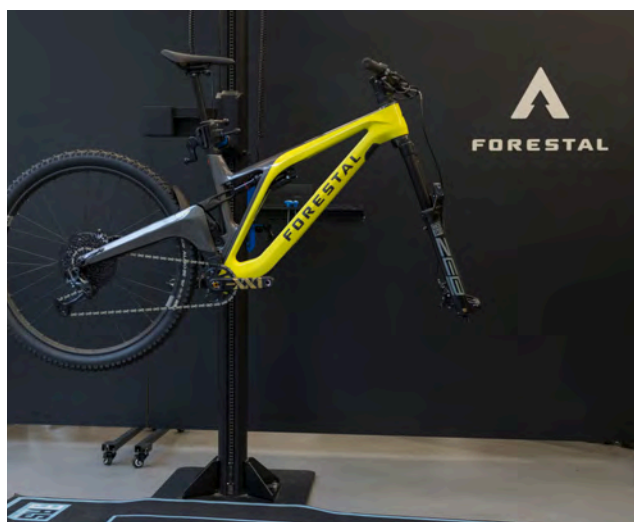

Step 1. Use a bicycle mount or lift the bicycle to install the wheel on the fork.



Step 2. Unscrew the front axle from the fork in order to be able to install the wheel on it.



Make sure the brake disc of the front wheel is aligned with the brake caliper attached to the fork, this is necessary to install the wheel correctly on the fork.



Check the correct movement of the wheel, you might need to align the front caliper if the disc is rubbing it when in motion.



Step 3. Install the wheel and insert the axle through the fork.



Step 4. Tighten the axle with a torque tool and a 6mm hex key using the manufactures torque indicated on the axle.



## Install the brake levers to the handlebar

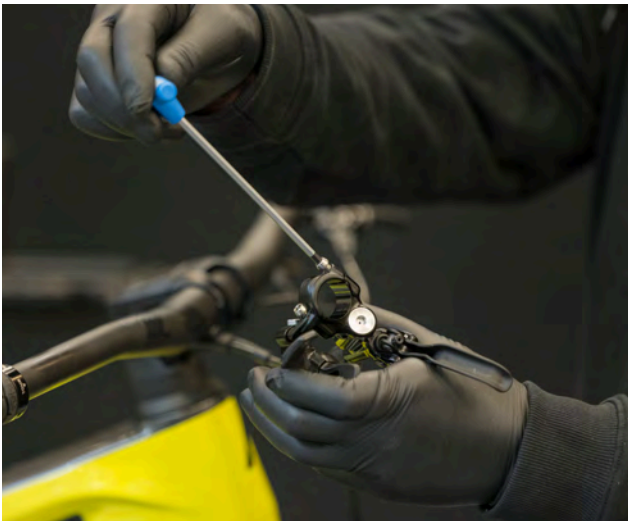

Step 1. Unscrew the brake clamp from the left or right brake lever using a 4mm hex key and place it on the handlebar to a desired position



Step 2. Install the lever clamp on the brake lever.



Formula brakes use a 'no gap' installation method when attaching to the handlebar. Ensure there is no gap between the top of the clamp and the brake lever during installation.



Step 3. Screw the top bolt first using a torque tool with a 4mm hex key at 4Nm.



Step 4. Follow the same steps in order to install the other brake to the handlebar.

## Install the lock-on grips



Step 1. Slide the lock-on grip to the handlebar.



Step 2. Tighten the lock-on grip to 2.5 – 4 Nm using a 3mm hex key.



Make sure that bicycle is placed not hanging from the service stand, but it's placed firmly at the ground with both wheels.

## Install the handlebars to the stem



Step 1. Correctly place the handlebars in the stem slot and make sure to secure them from moving by applying the pressure to the stem clamp.



Make sure that bicycle is placed not hanging from the service stand, but it's placed firmly at the ground with both wheels.



Step 2. Tighten the T25 bolts on top of the stem clamp to 6 Nm.





Step 3. Add two 4 mm hex bolts to the front of the stem clamp and tight it to 6 Nm.

### Install the integrated handlebars

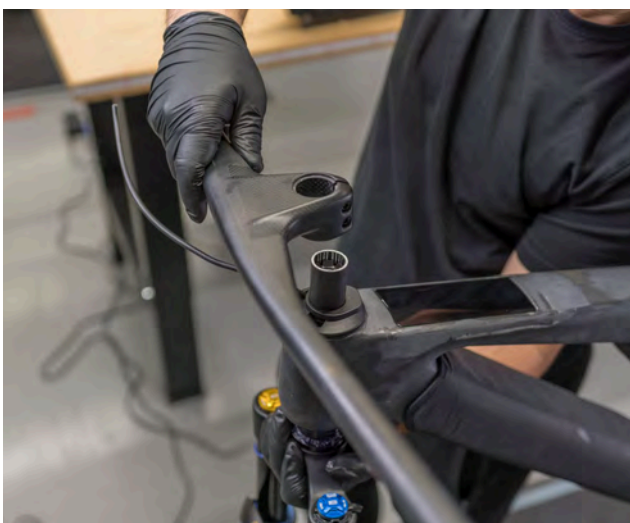

Step 1. Correctly place the handlebars in the steerer and make sure to slide it firmly all the way to the first stem spacer.



Step 2. Tighten the stem top cap with 4 mm hex key to 5 Nm of torque making sure that fork is sitting at the correct position.



Make sure that bicycle is placed not hanging from the service stand, but it's placed firmly at the ground with both wheels.

Step 3. Secure the stem to the steerer by tightening the two side bolts with a 4mm hex key to a 6 Nm of torque.



All the information needed to carry out the assembly and adjustment operations left to the consumer, or likely to be carried out by the consumer in the context of reasonably foreseeable use of the bicycle is available in this QR code.



## Brakes instructions

Please note that Forestal is shipping bicycles with the right brake that is operating the rear wheel and with the left brake that is operating the front wheel.

Follow all necessary instructions from the brake manufacturer to properly burnish and bed-in rotors and brake pads before any serious use of the bicycle. Following those instructions, you are ensuring that you will have secure brakes and be able to unleash their full potential.

Right / Rear brake

Left / Front brake



# Technical Characteristics

In this chapter, you will be familiarised with the technical aspects of your bicycle.

## Sizing chart Cygnus/Siryon

### Small / Medium

Recommended height  
160 – 177 cm

### Large

Recommended height  
175 cm – 187 cm

### Extra Large

Recommended height  
> 185 cm



Size recommendations are based on a standard fit. For advice about sizing please feel free to contact our customer service team at [contact@forestal.com](mailto:contact@forestal.com)

## ASTM category and terrain type

### Cygnus

Recommended for mild to moderate off-road terrains

Cygnus bicycle model is designed to handle a wide range of off-road terrains. It perform exceptionally well on natural trails, dirt paths, and forested routes, where the terrain may include moderate climbs, descents, and uneven surfaces like gravel or rocks. These bikes are built for efficiency and speed on mixed terrain, making them ideal for riding on rugged singletracks, open fields, and hilly landscapes. While XC and DC bicycle can manage some technical sections, they are best suited for endurance rides over undulating, varied terrain rather than extreme downhill or highly technical routes.



These bicycle are specifically designed for use on the terrain types outlined in this manual. Using it on unsuitable surfaces—such as rough off-road paths, steep hills, or highly uneven terrain—can lead to loss of control, damage to the bicycle, and personal injury. Always ride on terrain appropriate for your bicycle's design and capabilities. Failure to do so may result in accidents, excessive wear, and may void your warranty. For your safety, avoid riding in conditions that exceed the bicycle's intended use.

### Total System Weight Limit

This mountain bike is designed to safely support a maximum total system weight of 120 kg (264 lbs). This includes the combined weight of the rider, the bicycle itself, and any additional luggage or accessories. Please note that this bicycle is not suitable for the installation of a luggage carrier, child seat or bicycle trailer. Exceeding this weight limit may compromise the performance, handling, and safety of the bicycle, potentially leading to damage or increased risk of accidents. Always ensure the total load remains within this limit for optimal performance and rider safety.

## Frame anatomy Cygnus

Every bicycle frame consist of the following parts:

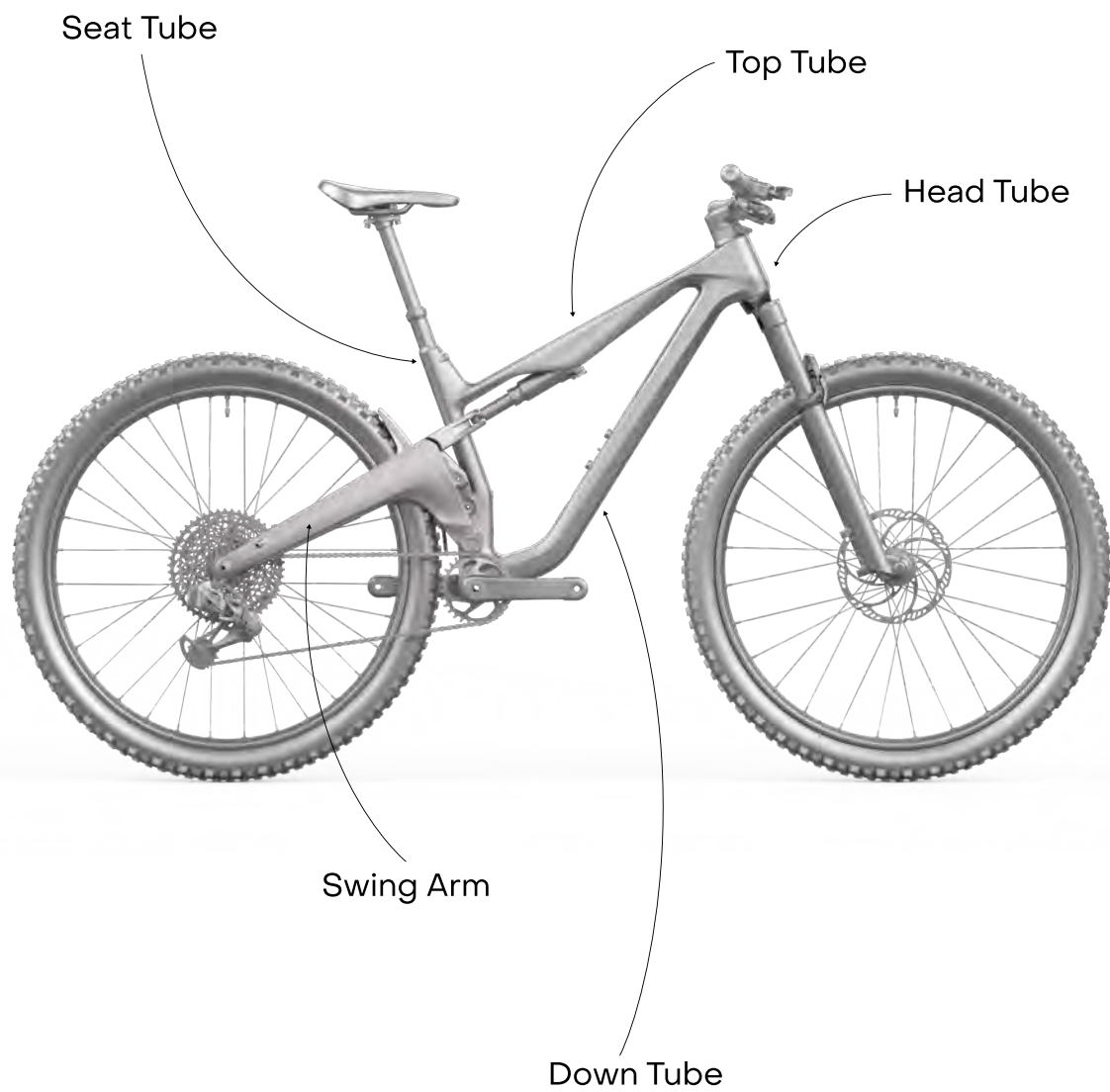

## Geometry chart Cygnus

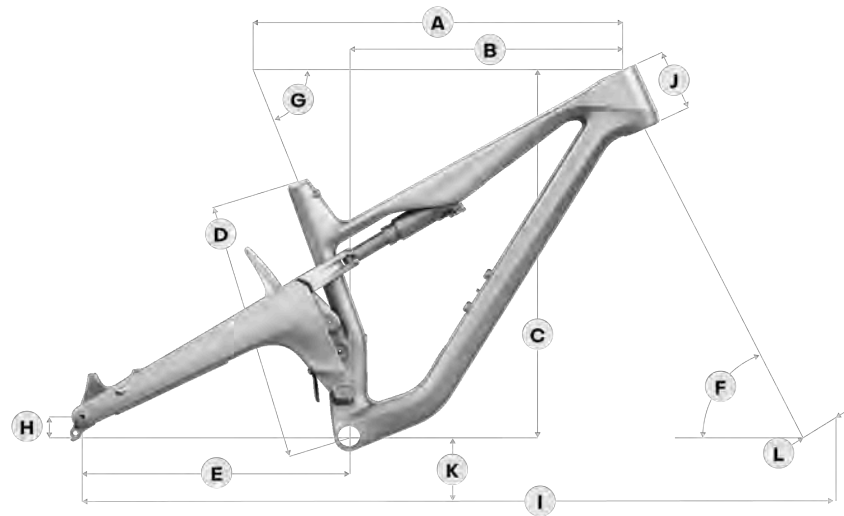

		<b>S/M</b>	<b>L</b>	<b>XL</b>
<b>A</b>	Top tube horizontal	595 mm	620 mm	650 mm
<b>B</b>	Reach	445 mm	470 mm	495 mm
<b>C</b>	Stack	602 mm	611 mm	625 mm
<b>D</b>	Seat tube lenght	415 mm	465 mm	500 mm
<b>E</b>	Chainstay horizontal	435 mm	435 mm	435 mm
<b>F</b>	Head tube angle	67 °	67 °	67 °
<b>G</b>	Seat tube angle	75 °	75 °	75 °
<b>H</b>	BB drop	-36 mm	-36 mm	-36 mm
<b>I</b>	Wheel base	1168 mm	1197 mm	1228 mm
<b>J</b>	Head tube length	100 mm	110 mm	125 mm
<b>K</b>	BB height	334 mm	334 mm	334 mm
<b>L</b>	Fork offset	44 mm	44 mm	44 mm

# Seatpost insertion Cygnus

Frame size	S/M	L	XL
Max. seatpost insertion	260 mm	300 mm	330 mm
Min. seatpost insertion	125 mm	150 mm	150 mm

The seatpost maximum extension mark is located on the backside of itself and should not be exceeded in any case. If the seat post mark and minimum frame insertion depths differ from each other, always use the longer measurement. If the maximum insertion point is reached, don't force the seat post deeper into the frame. By forcing the seatpost deeper, you can damage the frame and seat post cable.



Maximum seatpost insertion depth is measured from the top of the rubber part of the seat tube and it refers to measurements in the frame.



Minimum insertion mark is located from the backside of the seatpost and should not be exceeded in any case.

## Frame specifications Cygnus

**Material** T700/800 Monocoque Carbon Fibre

**Fork Travel** 120 mm

**Max Recommended Fork Travel** 130 mm

**Axle To Crown** 531 mm

**Fork Offset** 44 mm

**Rear Travel** 120 mm

**Wheels Size** 29"

**Recommended Shock Sag** 20–25% (10 mm – 12,5 mm)

**Shock Size** 210 x 50 mm

**Shock Compability** Air (w.lockout remote)

**Shock Hardware F (shaft)** 20 x 8 mm

**Shock Hardware R (body)** 15 x 8 mm

**Headtube** 56 mm upper and lower bore

**Headset** ZS56/ZS56 with knock-block in lower cup

**Bearings Required** 6x61802–2RS; 2xBushing kit  
20x18x6; 2x61804–2RS

**Seatpost** 31,6 mm  
(Internal Routing for Dropper Seatpost)

**Seat Clamp** 36,4 mm with rubber cap

**BB** Threaded 73 mm BSA

**Rear Hub** Boost 148 x 12 mm

**Rear Axle** Stealth M12 x 1.0

**Max Chainring Size** 36T/34T Oval

**Brake Mount** 180 mm Post mount

**Protection** 3D Countoured Rubber Frame  
Protection for DT/SS/CS

**Internal Storage** Fidlock magnetic lock with  
Fidlock bottle base and tool bag

# Suspension curve Cygnus

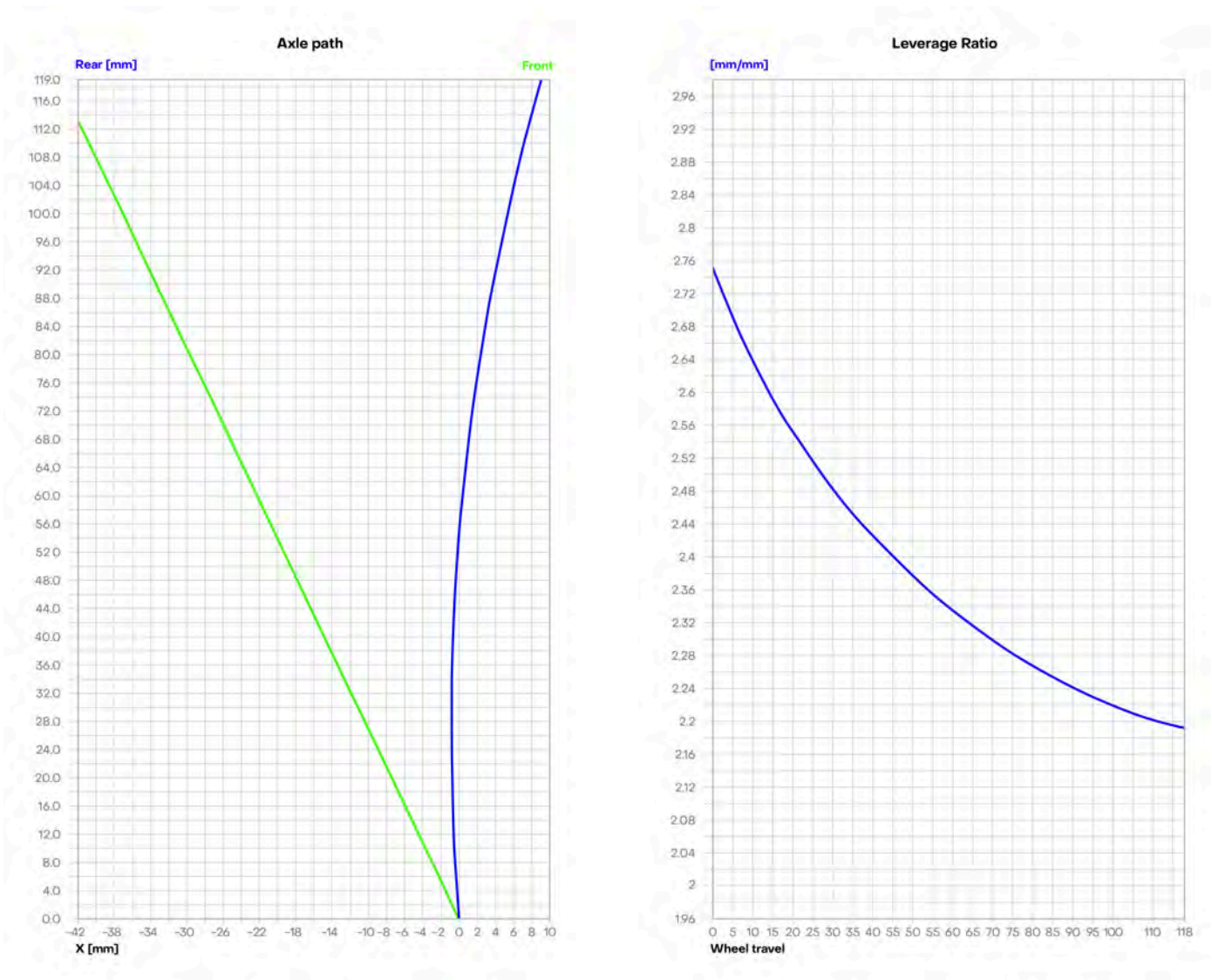

## Rear spacing Cygnus

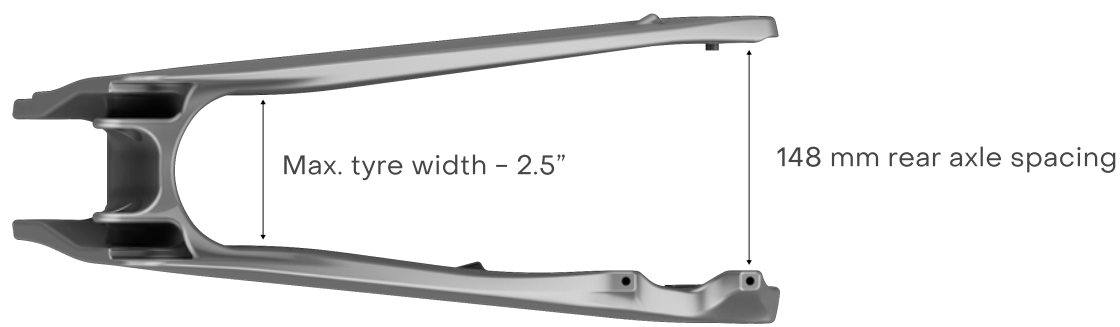



# Torque diagram Cygnus

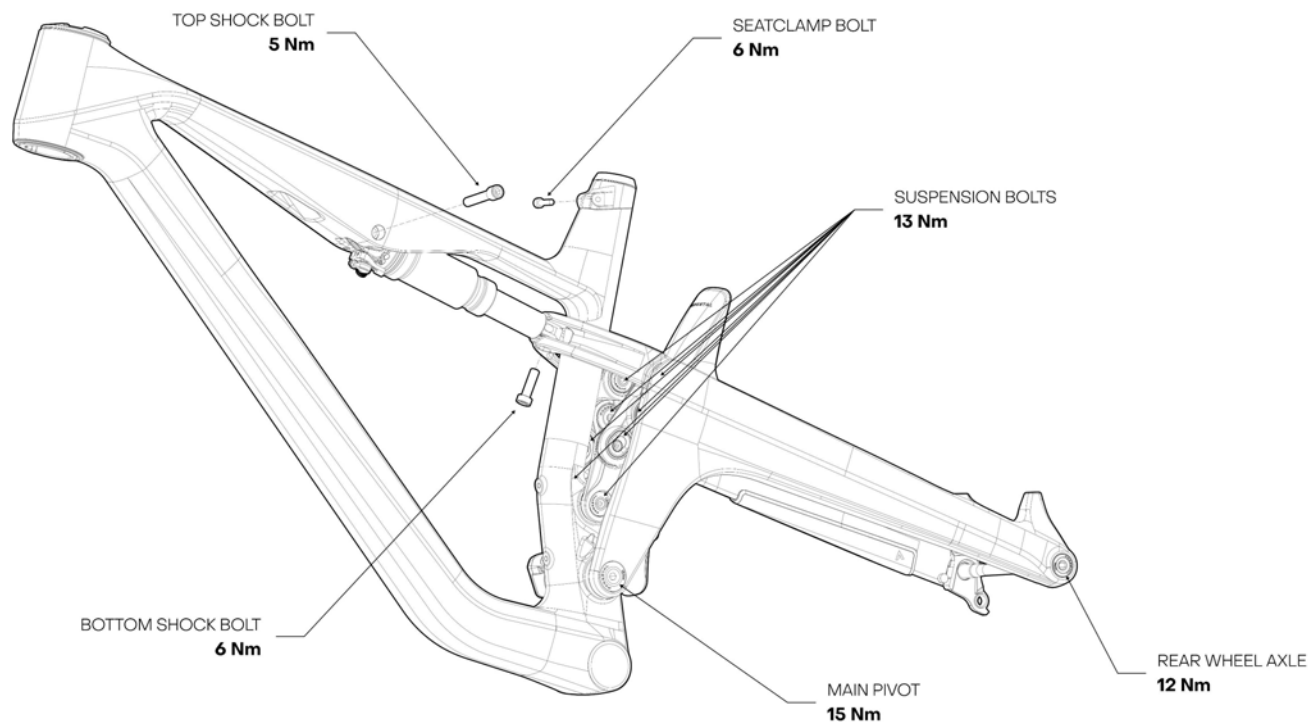

## Torque recomendation - Frame

	Newton-metre (Nm)	Pound-foot (lbf·ft)
Top Shock bolt	8 Nm	5.9 lbf·ft
Seatclamp bolt	6 Nm	4.4 lbf·ft
Bottom Shock bolt	6 Nm	4.4 lbf·ft
Suspension bolt	13 Nm	9.6 lbf·ft
Real wheel axle	12 Nm	8.9 lbf·ft
Main pivot bolt	15 Nm	11.1 lbf·ft

## Exploded view Cygnus

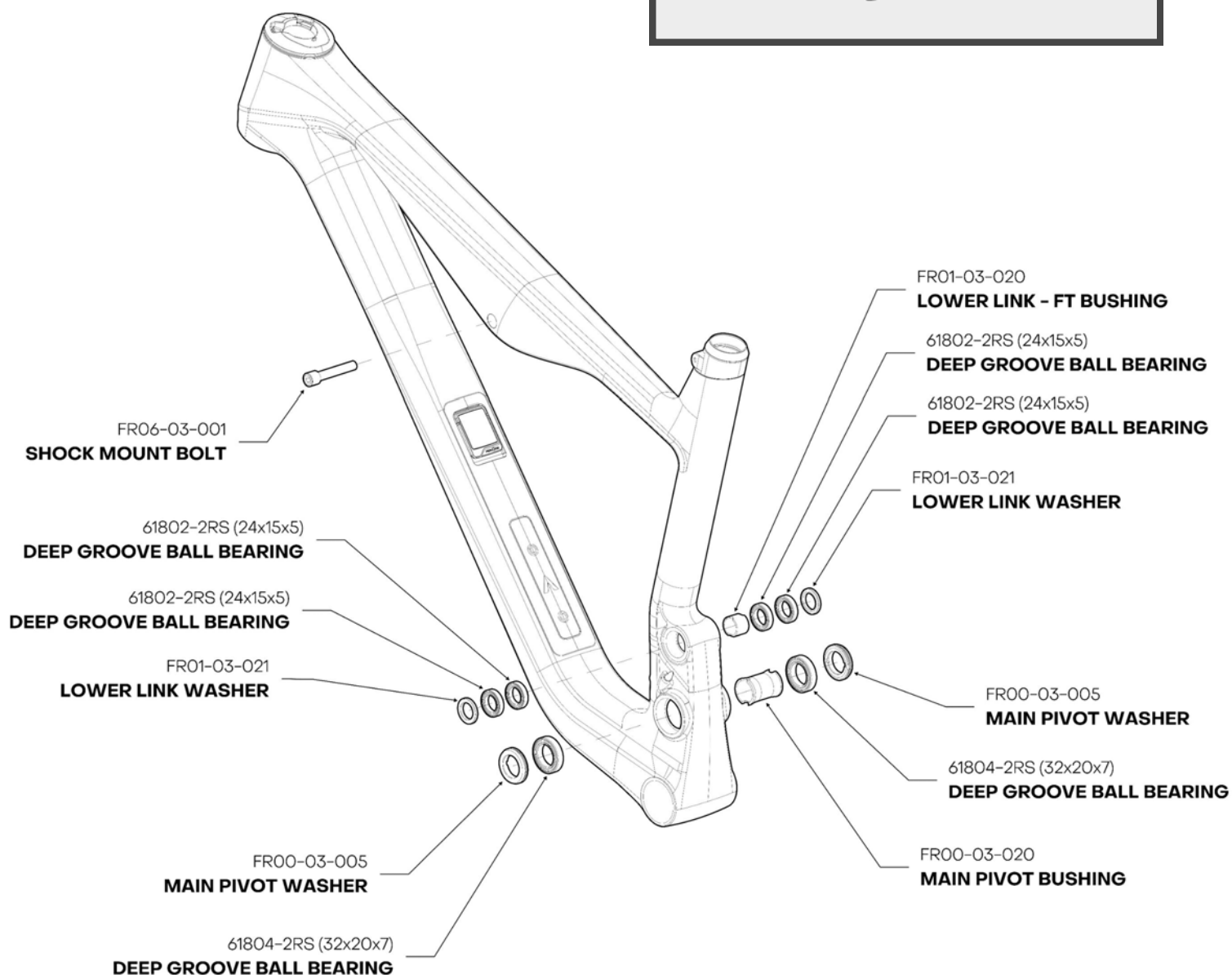
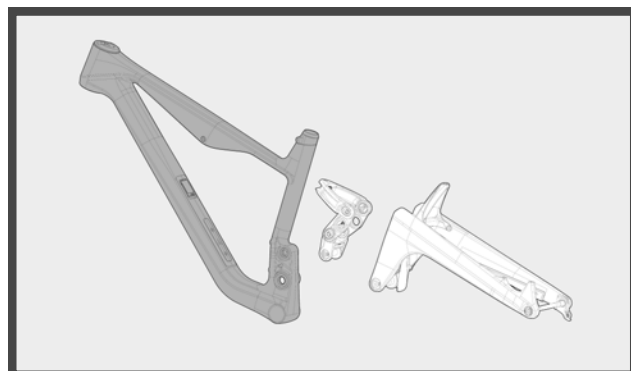

Before assembly, apply a thin coat of grease to the bolt body as well as blue thread-locker on bolt threads.



Use only the original Forestal parts available from the Forestal website or catalog.

# Exploded view Cygnus

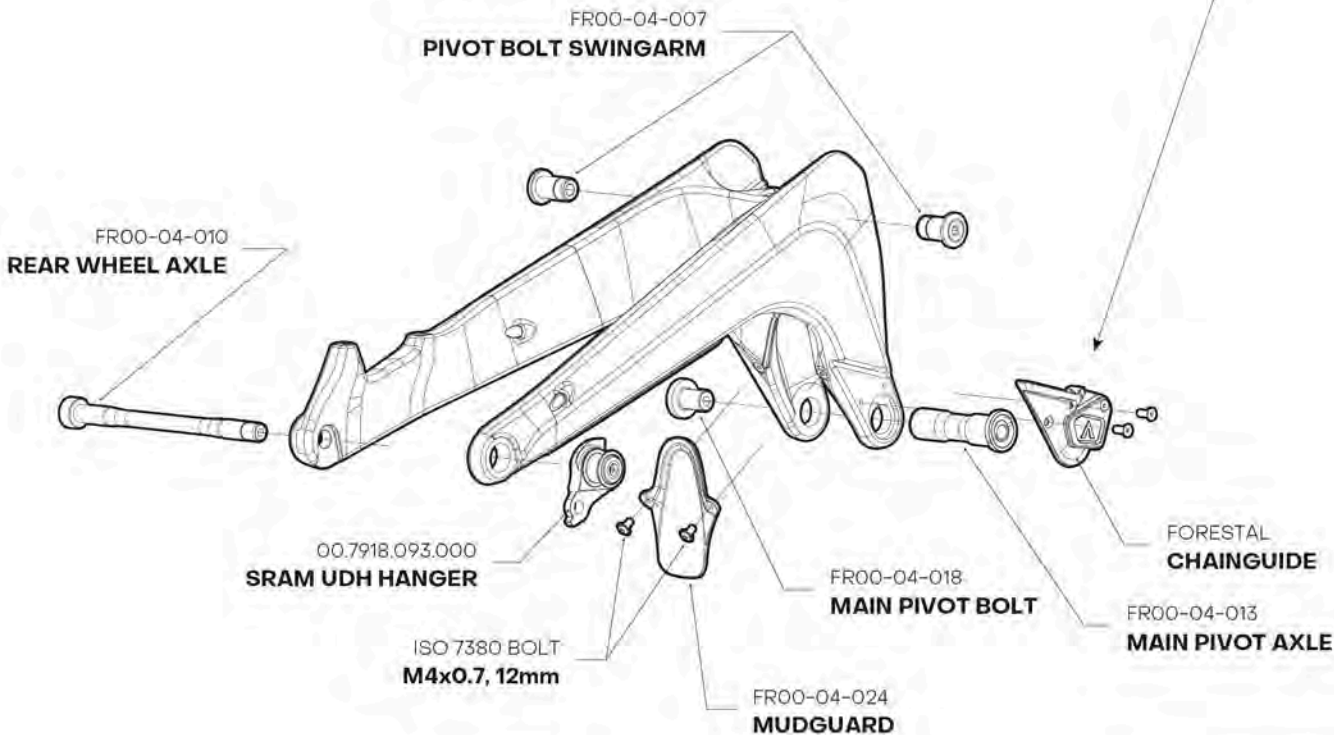
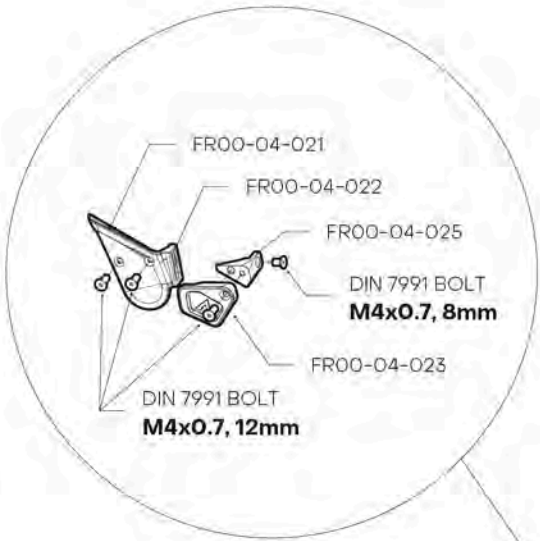
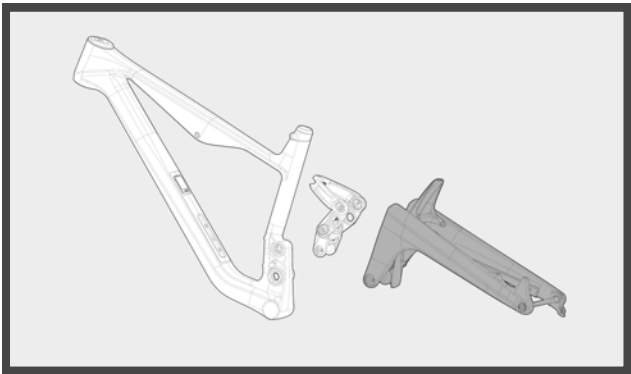

## Exploded view Cygnus



Always use blue thread-locker whenever you assemble the linkage.

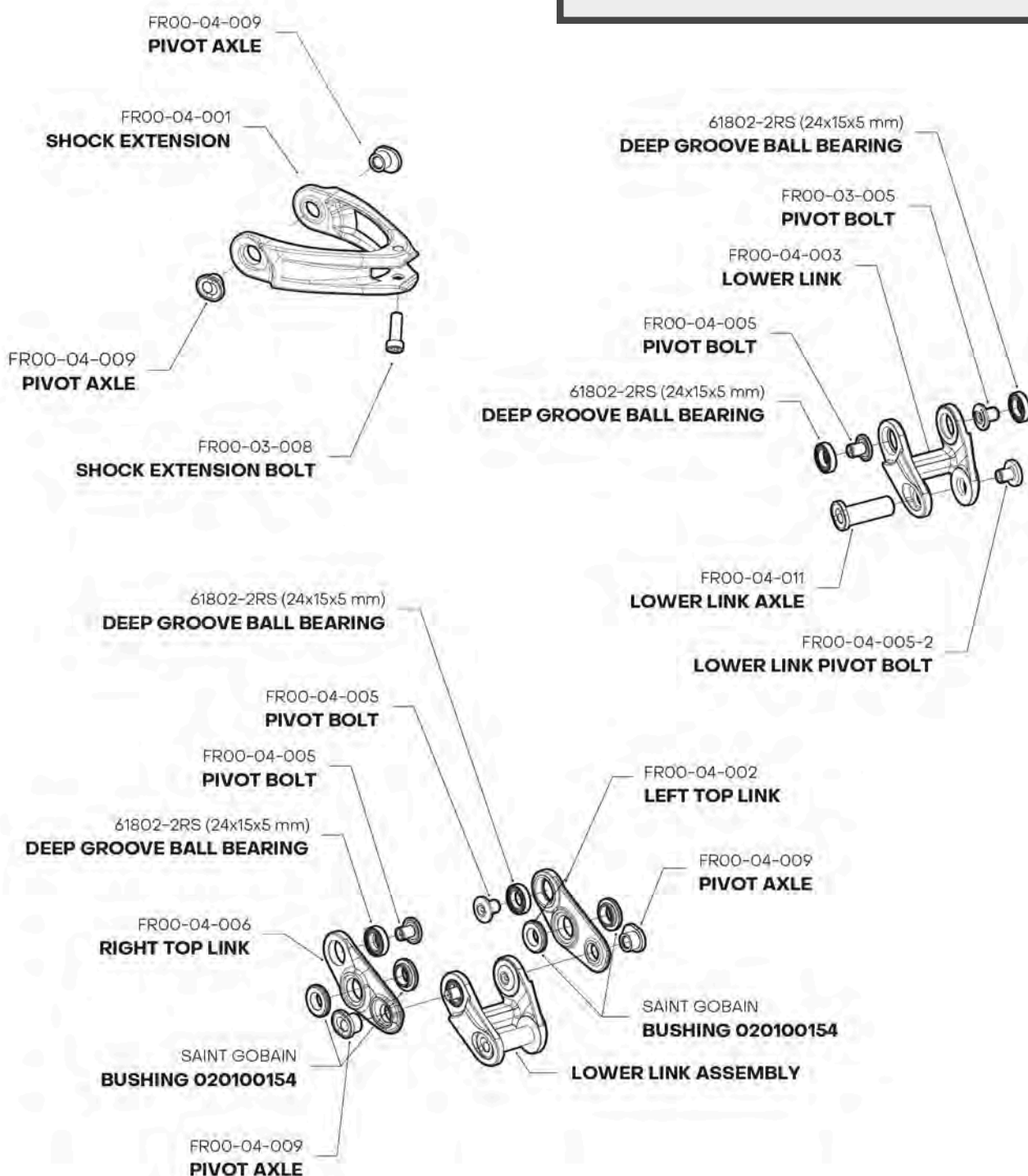
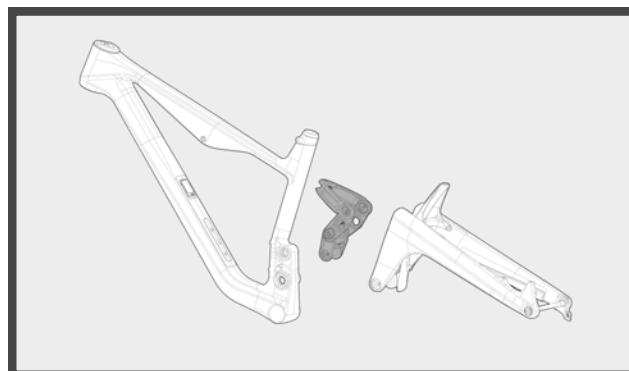

## ASTM category

### Siryon

Recommended for rough trails and Enduro descents.

The Enduro bicycle is engineered for tackling rough, gravity-oriented trails with confidence. It excels on steep descents, challenging obstacles, and technical downhill sections. With its rugged construction, this bike is perfect for riding through rocky terrain, root-laden paths, and harsh conditions where control and stability are paramount. Built for both technical climbs and aggressive downhill runs, the Enduro model thrives on extreme, unpredictable environments, offering riders the performance they need to conquer the most demanding landscapes. While it can handle uphill segments, its true strength lies in descending and navigating rough, unpredictable trails.

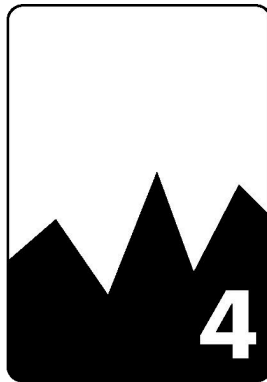

These bicycle are specifically designed for use on the terrain types outlined in this manual. Using it on unsuitable surfaces—such as rough off-road paths, steep hills, or highly uneven terrain—can lead to loss of control, damage to the bicycle, and personal injury. Always ride on terrain appropriate for your bicycle's design and capabilities. Failure to do so may result in accidents, excessive wear, and may void your warranty. For your safety, avoid riding in conditions that exceed the bicycle's intended use.

## Total System Weight Limit

This mountain bike is designed to safely support a maximum total system weight of 120 kg (264 lbs). This includes the combined weight of the rider, the bicycle itself, and any additional luggage or accessories. Please note that this bicycle is not suitable for the installation of a luggage carrier, child seat or bicycle trailer. Exceeding this weight limit may compromise the performance, handling, and safety of the bicycle, potentially leading to damage or increased risk of accidents. Always ensure the total load remains within this limit for optimal performance and rider safety.

## Frame anatomy Siryon

Every bicycle frame consist of the following parts:

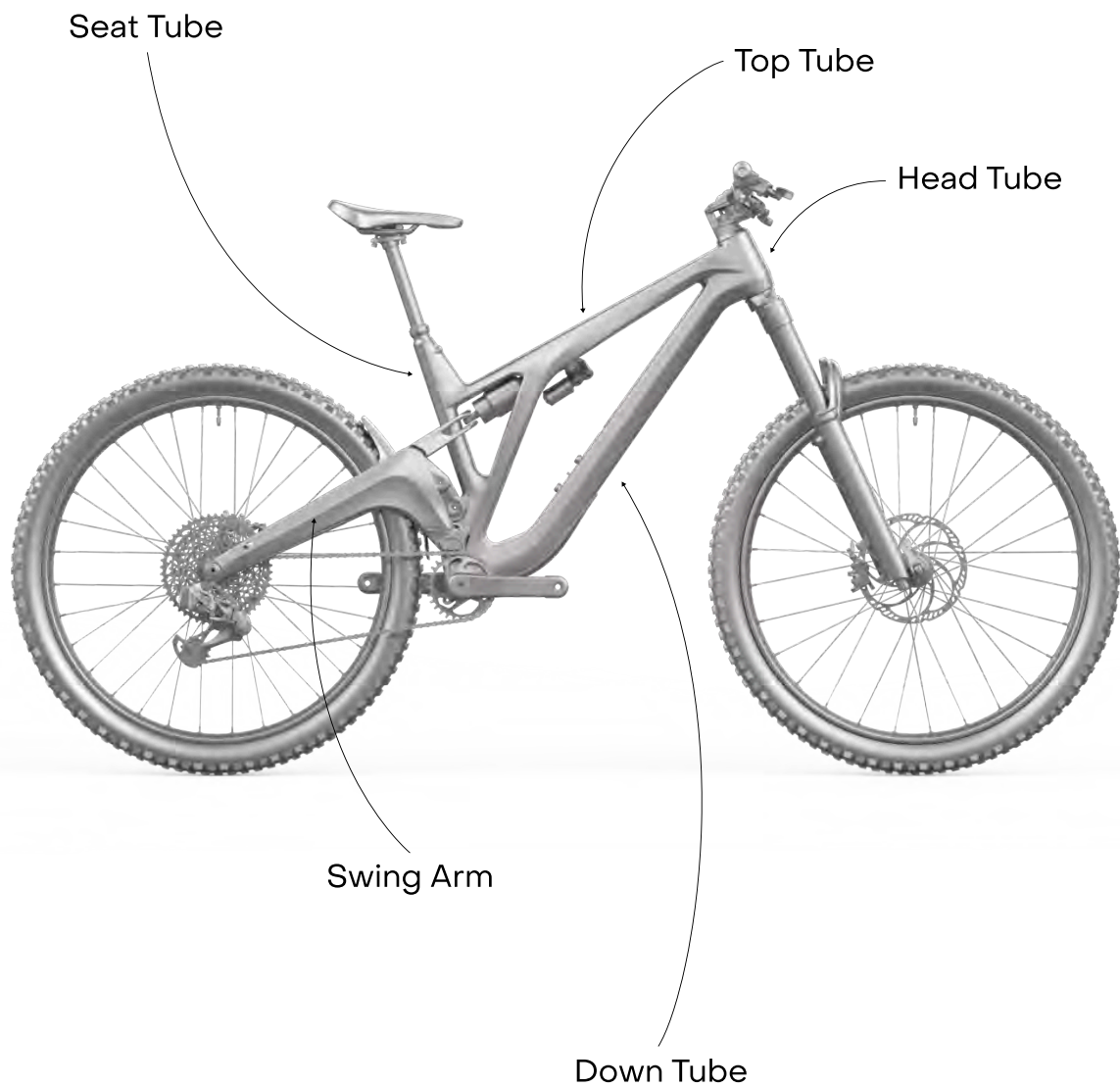

## Geometry chart Siryon

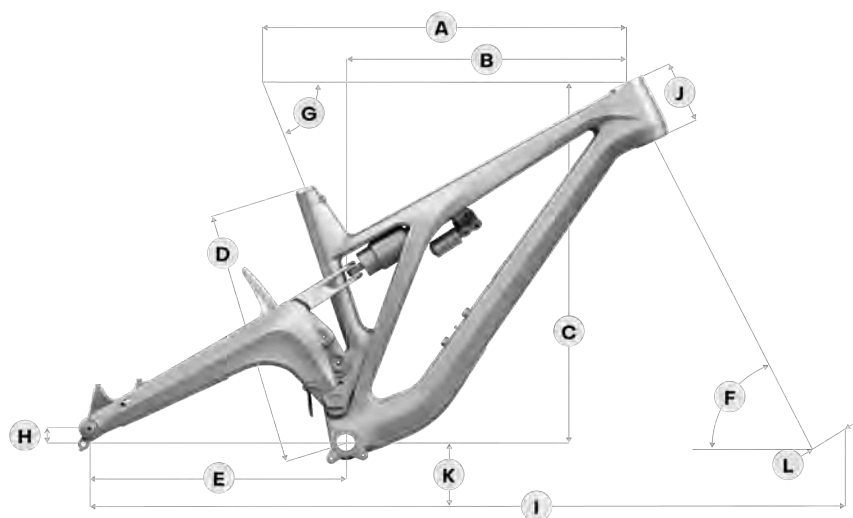

		<b>S/M</b>	<b>L</b>	<b>XL</b>
<b>A</b>	Top tube horizontal	596 mm	642 mm	606 mm
<b>B</b>	Reach	458 mm	488 mm	508 mm
<b>C</b>	Stack	623 mm	638 mm	650 mm
<b>D</b>	Seat tube lenght	410 mm	440 mm	475 mm
<b>E</b>	Chainstay horizontal	435 mm	445 mm	445 mm
<b>F</b>	Head tube angle	64,5 °	64,5 °	64,5 °
<b>G</b>	Seat tube angle	77,5 °	77,5 °	75.5 °
<b>H</b>	BB drop	-25 mm	-25 mm	-25 mm
<b>I</b>	Wheel base	1227 mm	1274 mm	1300 mm
<b>J</b>	Head tube length	95 mm	110 mm	125 mm
<b>K</b>	BB height	350 mm	350 mm	350 mm
<b>L</b>	Fork offset	44 mm	44 mm	44 mm

# Seatpost insertion Siryon

Frame size	S/M	L	XL
Max. seatpost insertion	250 mm	280 mm	320 mm
Min. seatpost insertion	125 mm	150 mm	150 mm

The seatpost maximum extension mark is located on the backside of itself and should not be exceeded in any case. If the seat post mark and minimum frame insertion depths differ from each other, always use the longer measurement. If the maximum insertion point is reached, don't force the seat post deeper into the frame. By forcing the seatpost deeper, you can damage the frame and seat post cable.



Maximum seatpost insertion depth is measured from the top of the rubber part of the seat tube and it refers to measurements in the frame.



Minimum insertion mark is located from the backside of the seatpost and should not be exceeded in any case.



## Frame specifications Siryon

**Material** T700/800 Monocoque Carbon Fibre

**Fork Travel** 170 mm

**Max Recommended Fork Travel** 190 mm

**Axle To Crown** 586 mm

**Fork Offset** 44 mm

**Rear Travel** 170 mm

**Wheels Size** 29"

**Recommended Shock Sag** 25–30% (16,2 mm – 19,5 mm)

**Shock Size** 230 x 65 mm

**Shock Compability** Air And Coil (Except EXT Aria)

**Shock Hardware F (shaft)** 15 x 8 mm

**Shock Hardware R (body)** 40 x 8 mm

**Headtube** 56 mm upper and lower bore

**Headset** ZS56/ZS56 with knock-block in lower cup

**Bearings Required** 6x61802–2RS; 2xBushing kit  
20x18x6; 2x61804–2RS

**Seatpost** 31,6 mm  
(Internal Routing for Dropper Seatpost)

**Seat Clamp** 36,4 mm with rubber cap

**BB** Threaded 73 mm BSA

**Rear Hub** Boost 148 x 12 mm

**Rear Axle** Stealth M12 x 1.0

**Max Chainring Size** 36T/34T Oval

**Brake Mount** 180 mm Post mount

**Protection** 3D Countoured Rubber Frame  
Protection for DT/SS/CS

**Internal Storage** Fidlock magnetic lock with  
Fidlock bottle base and tool bag

# Suspension curve Siryon

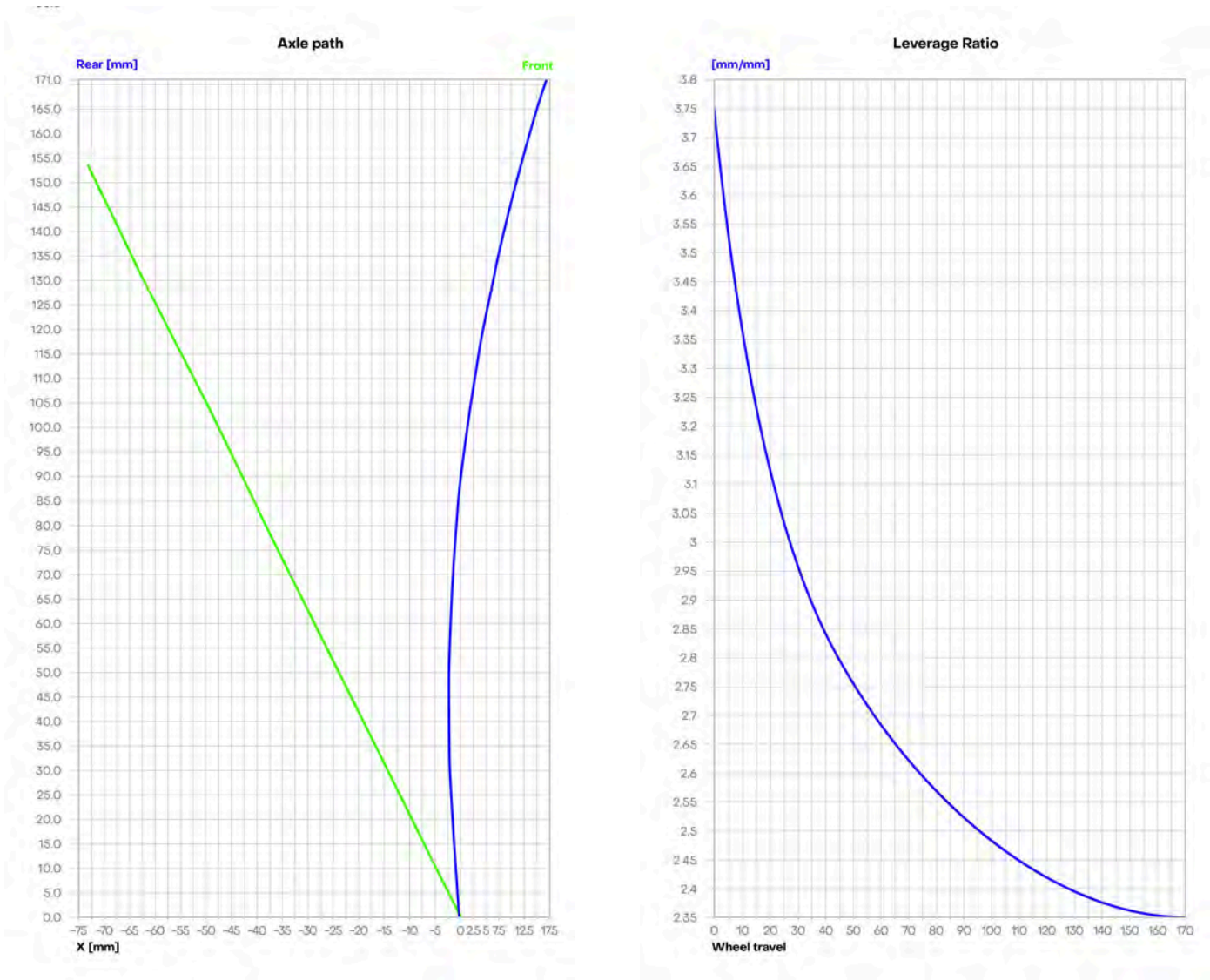

## Rear spacing Siryon



# Torque diagram Siryon

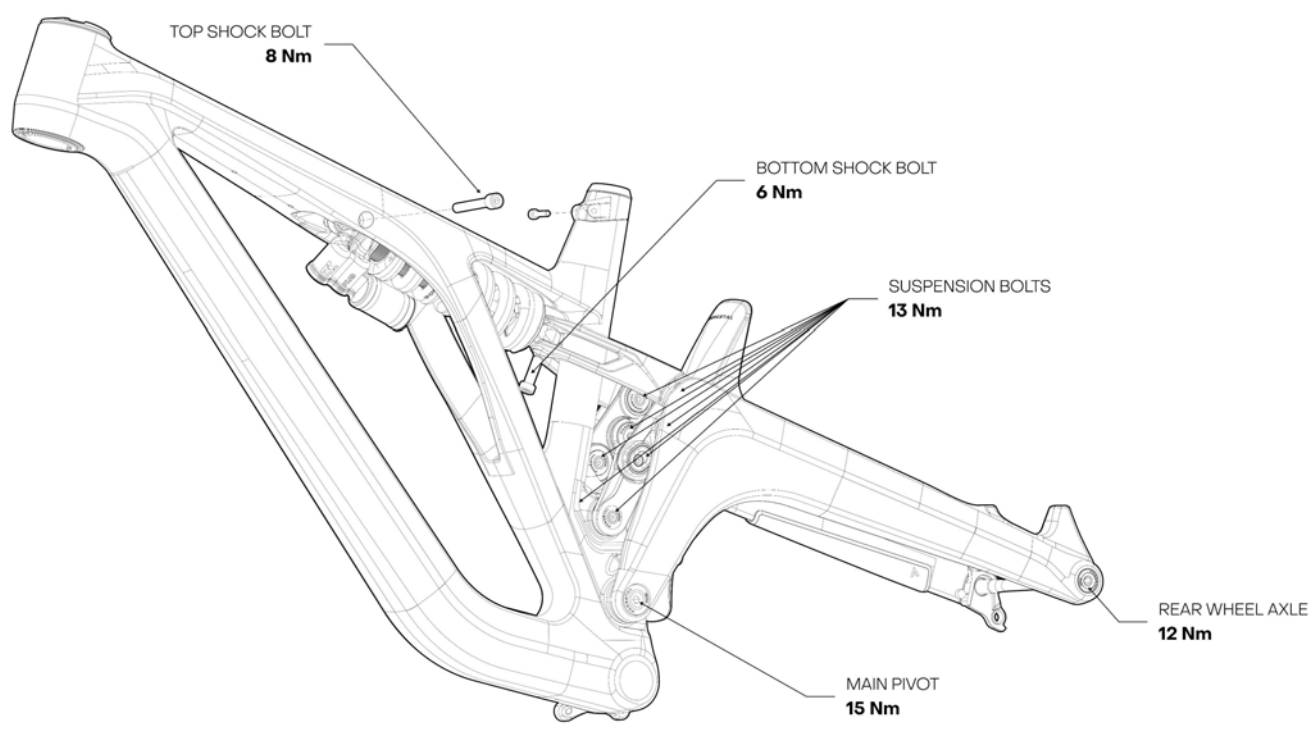

## Torque recomendation - Frame

	Newton-metre (Nm)	Pound-foot (lbf·ft)
Top Shock bolt	8 Nm	5.9 lbf·ft
Seatclamp bolt	6 Nm	4.4 lbf·ft
Bottom Shock bolt	6 Nm	4.4 lbf·ft
Suspension bolt	13 Nm	9.6 lbf·ft
Real wheel axle	12 Nm	8.9 lbf·ft
Main pivot bolt	15 Nm	11.1 lbf·ft

## Exploded view Siryon

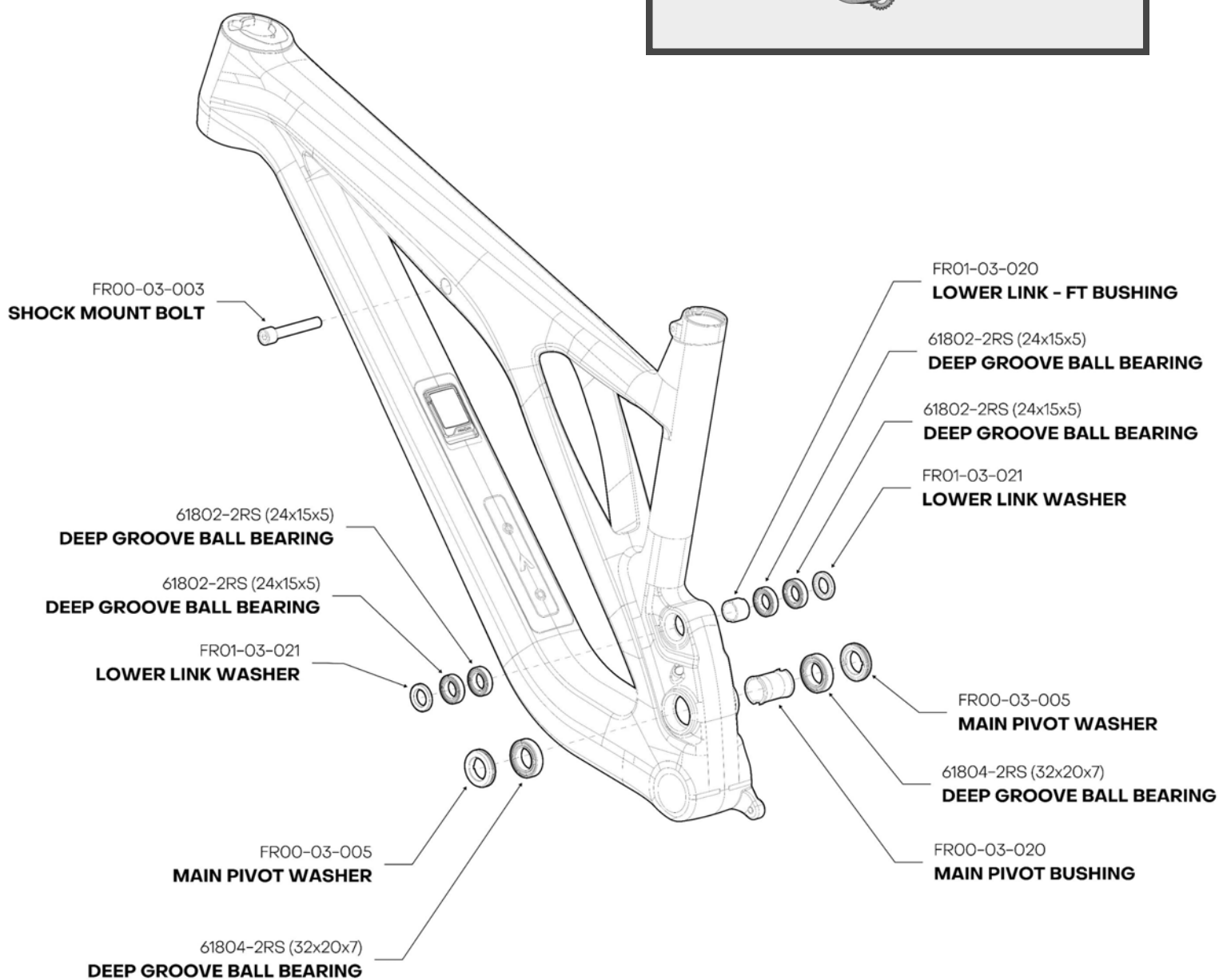
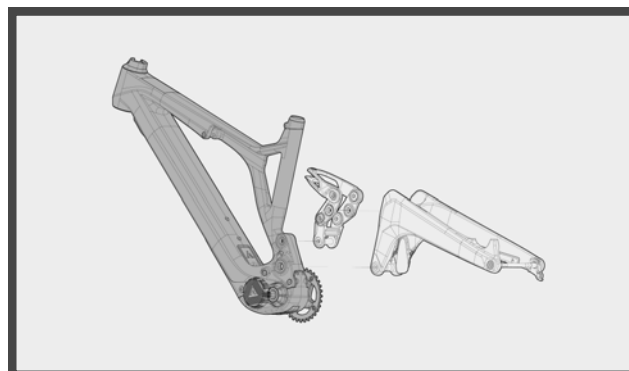

Before assembly, apply a thin coat of grease to the bolt body as well as blue thread-locker on bolt threads.



Use only the original Forestal parts available from the Forestal website or catalog.

## Exploded view Siryon

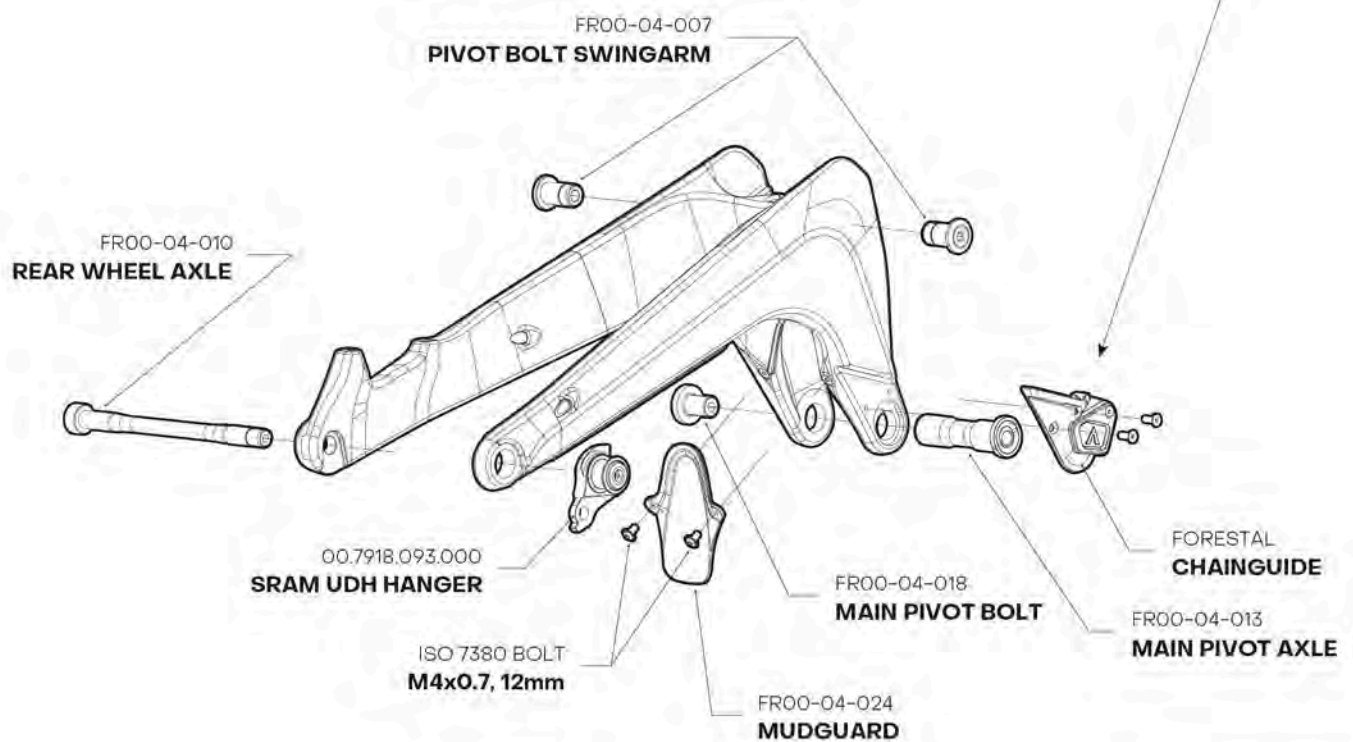
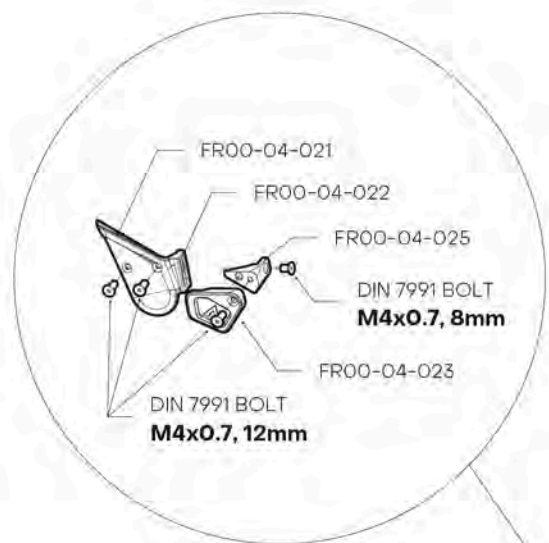
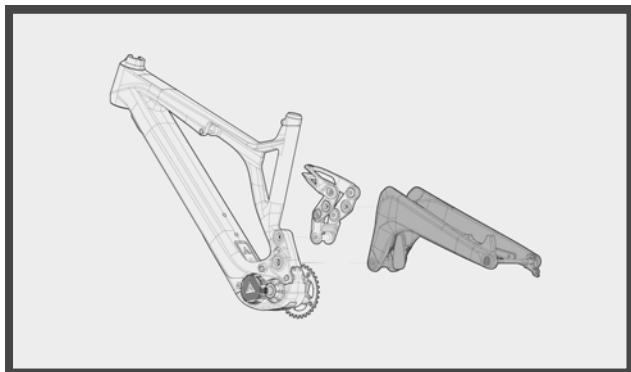

## Exploded view Siryon



Always use blue thread-locker whenever you assemble the linkage.

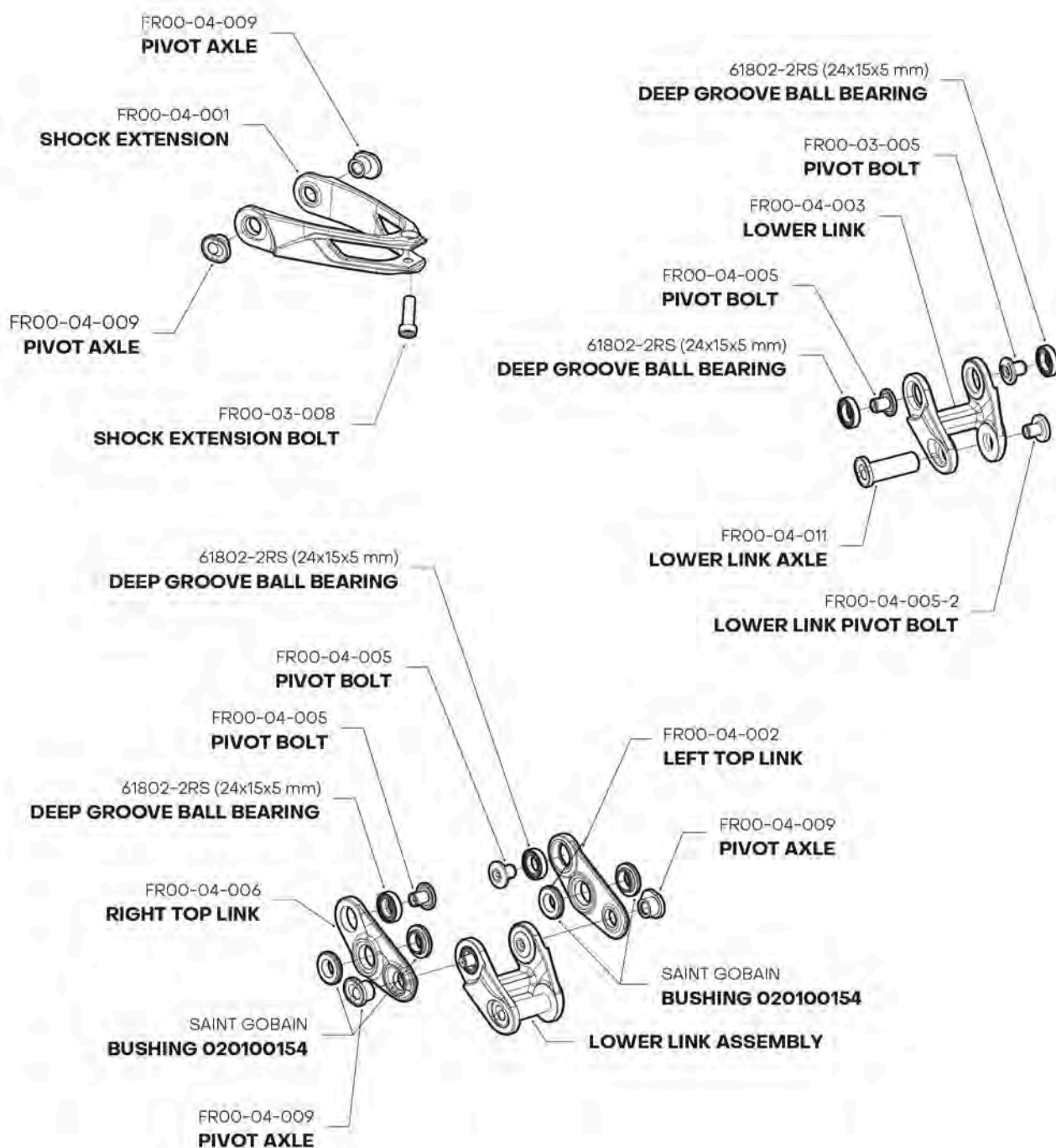
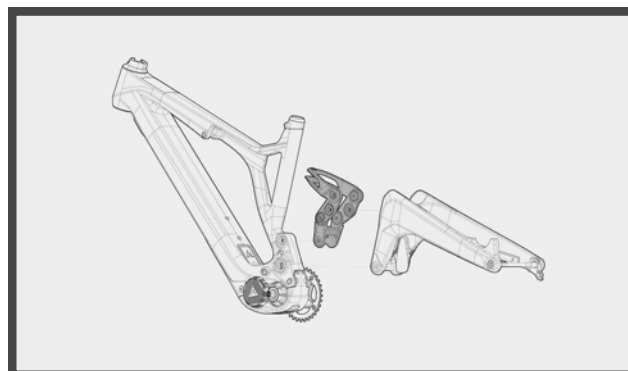

## Components torque table Cygnus / Siryon

Torque - Components	Newton-metre (Nm)	Pound-foot (lbf·ft)
Lock-on grips	2.5 – 4 Nm	1.8 – 2.9 lbf·ft
Shifter to handlebar	2.5 – 4 Nm	1.8 – 2.9 lbf·ft
Brake lever to handlebar	4 Nm	2.9 lbf·ft
Headset Stem top cap	5 Nm	3.7 lbf·ft
Stem to handlebar clamp	6 Nm	4.4 lbf·ft
Stem to steering tube	7.2 Nm	5.3 lbf·ft
Seatpost bolt	5 Nm	3.7 lbf·ft
Wheels thru axle	40 Nm	29.5 lbf·ft
Cassette retainer	40 Nm	29.5 lbf·ft
Disc brake rotor to hub	6 Nm	4.4 lbf·ft
Disc brake caliper to frame / fork	6 Nm	4.4 lbf·ft
Rear derailleur fixing bolt	11 Nm	8.1 lbf·ft
Derailleur cable bolt	5 Nm	3.7 lbf·ft
Chainring bolts	8 – 9 Nm	5.9 – 6.6 lbf·ft
Pedals to the cranks	30 Nm	22.1 lbf·ft

This list provides some guidelines but is not to be considered a complete representation of needed service. Following these guidelines will help maintain the performance of your bicycle and prevent more serious problems from arising. For service instructions and torque values for your specific components, visit the manufacturer's website.

## Internal storage

Internal storage compartment serves as an additional storage solution in the frame. Equipped with Fidlock magnetic closure system it ensures smooth and user friendly operation. Together with Fidlock integrated bottle base it provides seamless integration between frame, storage and water bottle. It includes a tool bag from Cordura material for longevity and easy carrying of the tools, Aerothan tube and various small items.



Internal storage lid with integrated magnetic closure and bottle base



Storage bag from Cordura fabric



After the use, make sure that the lid is properly closed before returning the water bottle on it.



## **Storing the bicycle**

We recommend that you protect your bicycle from outside elements and store it in a clean and dry place at a temperature from 10 – 25 °C (50 – 77 °F). Before storing your bicycle for a longer period of time, it is recommended that you clean the whole bicycle, lubricate all moving parts and deflate the tyres to about the half of the normal tyre pressure.

By following this method, you will extend the life of the bicycle and its components.

## **Transportation**

Whether it is for travelling, warranty or maintenance purposes, we strongly recommend you to use your bicycle's eco-friendly box. You can re-pack your bicycle in it by using all the packaging parts that originally came with the bicycle and by following packing/unpacking procedure that you can find on our website. In case of transportation by air, make sure to contact your particular airline for further advice.

## **Adjustment of gears and operation**

To operate SRAM Eagle, use the right shifter (big lever for easier gears, small lever for harder gears) and pedal lightly while shifting. For adjustment: Ensure the derailleur hanger is straight, align the derailleur with the smallest and largest cogs using the limit screws, set the B-gap with the SRAM tool, fine-tune cable tension with the barrel adjuster, and test ride to finalize.

# Warranty

At Forestal we are committed to providing a first-class brand experience, not only by creating the most innovative and extraordinary products but also by being close and accessible to our customers when they need us the most.

For this reason, we are offering a Global Warranty policy for users who register their bicycle through Forestal Sync App:

## **Frame warranty: 7 Years**

Normally you will read “lifetime warranty”, but this is related to the material’s lifetime. According to our research, we consider 7 years to be the optimal lifespan for carbon fibre.

## **Paint and graphics: 2 Years**

Under any circumstances except physical damage due to the careless use of the bicycle.

## **Other Forestal branded components: 2 Years**

Under any circumstances except physical damage due to the careless use of the bicycle.

The rest of the non-Forestal components will be covered by the warranty of its related third party suppliers and manufacturer. Information about the conditions will be included with each bicycle in form of dedicated original instruction manuals.

Consumable parts including but not limited to tyres, bearings, brake pads, chains, chainrings, and cassettes are not covered by the warranty.

Incorrect use or modification to the bicycle frame in any way that may change its design or intended use and operation may lead to voiding the warranty.

The warranty will begin from the moment in which the bicycle is delivered to its first owner but also, the warranty is transferable, taking into consideration that it will be calculated from the delivery date to the original owner.

Transferring the bicycle’s ownership and warranty from one user to another can be achieved via the Forestal App, where a unique confirmation code will be sent to both parties to approve the transaction.

From that point, the second user will become the registered owner of the bicycle and by that they gain all consumer rights and possession of the eventual warranty claims.

## Rewind Programme

Forestal wants to make sure that our customers stay with the brand, therefore we are offering special pricing for those who are not eligible for a warranty. The Rewind Programme helps users to “go back in time” to avoid that precise moment in which their Forestal bicycle was severely damaged. You will find more information on the warranty page of our website. If you would like to take advantage of the Rewind Programme or have any related questions please email us at [contact@forestal.com](mailto:contact@forestal.com) and our customer service team will gladly assist you.



It is necessary to register your bicycle before the first ride in order to activate the warranty, and be able to use all benefits of rewind programme.

# Disclaimers & Warnings

Please read the user manual carefully and follow all the recommended procedures.

By following this, you are extending the lifespan of your bicycle and preventing potentially dangerous situations and injuries to you or third parties.



Forestal is not responsible for any damage or injuries caused to you or third parties by the use or incorrect assembly of this bicycle or any product contained in this box.



The user manual is subject to change without previous notice. We will always try to improve the methods and the quality of our information and processes that are contained in this manual to provide a better user experience.



Use only original spare parts and Forestal parts that you can find on our website.



Incorrect use or modifications to the bicycle frame in any way affecting the design or intended use and operation will lead to voiding the warranty and render your bicycle not in compliance with the applicable consumer rights and regulations.

# Declaration of Conformity

With this declaration of conformity, the Manufacturer:  
FORESTAL GROUP, S.L.U.  
Borda del Prat de La Font, s/n  
AD400 Arinsal  
Andorra



**We hereby declare, on our sole responsibility as manufacturers that:  
The bicycles, year of construction 2024, and hereinafter referred to as**

Description	Ref. Number
Siryon Halo, Citrine Jet, S/M	F6.256010206
Siryon Halo, Citrine Jet, L	F6.256010306
Siryon Halo, Citrine Jet, XL	F6.256010406
Siryon Diode, Seasalt Cerulean, S/M	F6.256030207
Siryon Diode, Seasalt Cerulean, L	F6.256030307
Siryon Diode, Seasalt Cerulean, XL	F6.256030407
Cygnus Halo, Blue Copper, S/M	F6.258010204
Cygnus Halo, Blue Copper, L	F6.258010304
Cygnus Halo, Blue Copper, XL	F6.258010404
Cygnus Diode, Dune Charcoal, S/M	F6.258010205
Cygnus Diode, Dune Charcoal, L	F6.258010305
Cygnus Diode, Dune Charcoal, XL	F6.258010405

Comply with the relevant provisions and have implemented the following harmonised standards:

**ISO 4210-2 (April 2018) Bicycles – Safety requirements for bicycles – Part 2: Requirements for city and touring bicycles, young adult bicycles, mountain and racing bicycles.**

Mr. Rafael Gil-Pérez Redondo, CEO of FORESTAL GROUP, S.L.U. and authorised to constitute the technical documentation

Andorra, 17th October 2024

**Rafael Gil-Pérez Redondo**  
CEO

# Thank you

for your purchase and for  
becoming an essential part of the  
Forestal team.

#BeTrueToYourNature

#RideForestal

If you have any questions, please do not hesitate  
in contacting us as we will gladly help you.

**Customer Service**

[contact@forestal.com](mailto:contact@forestal.com)

+376 737 704

Carretera General 2, Km 4, Local 5, Nau 2, Naus Illes Bartra  
AD200 Encamp – Andorra

**Company address**

FORESTAL GROUP, S.L.U.  
Borda del Prat de La Font, sn  
AD400 Arinsal – Andorra

**FORESTAL**

[forestal.com](https://forestal.com)